



ROYAL PALM

BEACHCOMBER LUXURY



A legend,
a reverie.

Hotel features



A member of The Leading Hotels of the World.

Protected from the trade winds, the sea is fringed by a pure white sandy beach.

A unique site on the sun-drenched north-west coast of Mauritius.

Personalised service provided by a team of dedicated Artisans.

3 restaurants offering a diversity of culinary experiences led by the Executive Chef William Girard.

69 spacious, elegantly decorated Suites facing the Indian Ocean.

3 tempered swimming pool during winter.

A spectacular Royal Suite with private pool.

Royal Palm Spa in partnership with Valmont.

A spacious Fitness Centre with up-to-date equipment and professional coaches.

A wide range of complimentary activities organised at Ti Royal Kids Club for children aged 3 to 11 years old.

Complimentary activities organized for teens aged 12 to 17 years old.

Access to Mont Choisy Le Golf, a 18-hole golf course located 10 minutes away from the resort.

Helipad.

Dining interchangeability with all Beachcomber Hotels (upon reservation).

Once at the hotel, guests have the possibility to stay in another Beachcomber property depending on availability.

Supplements may be applicable according to the chosen room category. Bookings directly at hotel.





Accommodation

SUITES

Junior Suite

Max Capacities **2 adults + 1 child**
Nº of Suites **27**
Living Area $\approx 60\text{m}^2$

Tropical Suite

Max Capacities **2 adults + 1 child**
Nº of Suites **4**
Living Area $\approx 85\text{m}^2$

Ocean Suite

Max Capacities **2 adults + 2 children**
Nº of Suites **21**
Living Area $\approx 125\text{m}^2$

Palm Suite

Max Capacities **2 adults + 2 children**
Nº of Suites **10**
Living Area $\approx 105\text{m}^2$

SIGNATURE SUITES

Penthouse

Ambre Island Suite

Max Capacities **2 adults + 1 child**
Nº of Suite **1**
Living Area $\approx 195\text{m}^2$

Presidential Suites

Crystal Rock Suite

Max Capacities **Up to 4 pax. Max 4 adults.**
Nº of Suites **1**
Living Area $\approx 260\text{m}^2$

Coin de Mire Suite

Max Capacities **Up to 4 pax. Max 4 adults.**
Nº of Suites **1**
Living Area $\approx 260\text{m}^2$

Gabriel Island Suite

Max Capacities **Up to 4 pax. Max 4 adults.**
Nº of Suites **1**
Living Area $\approx 260\text{m}^2$

Romance Suite

Max Capacities **2 adults + 1 child**
Nº of Suites **2**
Living Area $\approx 125\text{m}^2$

ROYAL SUITE

Max Capacities **Up to 4 pax. Max 4 adults.**
Nº of Suites **1**
Living Area $\approx 385\text{m}^2$

Various possibilities of connecting suites to accommodate families.

SUITES AMENITIES

All suites are sea-facing and possess the following facilities:

- Terrace/ Balcony
- Air-conditioning
- WI-FI access
- Bathroom with separate bathtub, shower and toilet(s)
- Walk-in wardrobe
- Individual safe
- Telephone with international direct dialling
- DVD & Fax (on request)
- Flat screen TV (satellite channels)
- Mini-bar
- Tea & coffee
- **Ambre Island Suite:** Personal butler service
- **Royal Suite & Presidential Suite:** Two separate bedrooms, two bathrooms, personal butler service

SUITE POLICY

- 24-hour room service
- Laundry, dry-cleaning and pressing service (service charge)
- Check-in is at 2 p.m. Check-out is at noon
- Lift located next to the reception
- One room for disabled persons on request
- Sunbed allocation with respect to room category



Highlights

ROMANCE SUITE

- Romantic welcome in room (flowers, candles, champagne)
- 1 massage per adult per stay
- A dedicated corner on the beach
- A romantic escapade at turndown once during your stay
- A stylish interior with a luxurious contemporary feel
- Spacious Suite with direct access to the beach

CRYSTAL ROCK SUITE, COIN DE MIRE SUITE, GABRIEL ISLAND SUITE

- A breath-taking view of the ocean
- A spacious suite; 260m² of living area, reflecting elegance and sophistication
- Modern interior with refined furnishings
- A large terrace featuring a lounge area, a table to enjoy alfresco meals and long chairs, facing the sea



ROYAL SUITE

- A privileged location facing the sea
- Direct access to the beach
- Own private pool
- A unique suite of 385m² with spacious and bright spaces
- Modern, luxurious and comfortable interior with character
- A delightful gazebo ideal for moments of relaxation

Room Plans



Junior Suite



Ocean Suite



Tropical Suite



Palm Suite



Romance Suite



Ambre Suite



Crystal Rock Suite,
Coin de Mire Suite,
Gabriel Island Suite

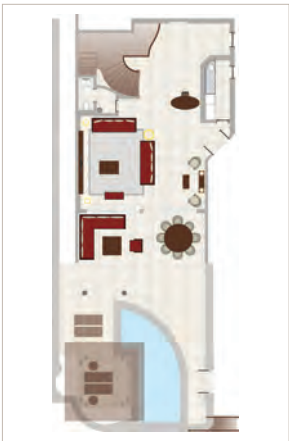

Royal Suite - Ground Floor



Royal Suite - First Floor

Restaurants

LA GOÉLETTE

Signature restaurant overlooking the bay.

Breakfast Buffet / A la Carte 7.30 a.m. to 10.30 a.m.

Dinner A la Carte 7.30 p.m. to 10.30 p.m.

Reservation Recommended / **Seats** 80

LE BAR PLAGE

Restaurant and beach bar.

Set under a magnificent badamier tree, offering guests a relaxed and casual atmosphere.

Lunch A la Carte 12.30 p.m. to 5 p.m. / **Seats** 70

Dinner A la Carte 7.30 p.m. to 10.30 p.m. / **Seats** 30

Reservation Required

LA BREZZA

Italian trattoria facing the lagoon.

Lunch A la Carte. On Friday, Saturday and Sunday from 12.30 p.m. to 3 p.m.

Dinner A la Carte 7.30 p.m. to 10.30 p.m.

Closed on Thursdays

Reservation Required / **Seats** 40

ROYAL GRILL

Pop-up restaurant on the beach every Thursday.

Dinner Buffet 8 p.m. to 10.30 p.m.

Reservation Required / **Seats** 80



Bars

THE BAR

Opens daily from 10 a.m.

LE BAR PLAGE

Opens daily from 10 a.m. to 4 p.m.

THE WINE CELLAR

Wine tasting experience according to your preferences and paired with a selection of tapas. Advance bookings required.

Entertainment

Daily live entertainment from 7 p.m.

Dress code

Daytime: swimwear or tank tops are not allowed.

Evening as from 7 p.m.: gentlemen are requested to wear collars, trousers and closed shoes.

Royal Grill: relaxed



Royal Palm Spa

18 massage and treatment rooms offering:

- Royal Palm signature treatment.
- Ayurvedic treatments.
- Reflexology
- Yoga, meditation
- Reiki
- 2 wet steam baths, 2 dry steam baths
- 1 hairdressing salon (by Leonor Greyl)
- 2 beauty salons
- 1 barber shop
- Bar
- 2 changing rooms
- 2 locker rooms
- Qi-Gong
- Makko Ho
- 5 Tibetans
- Respiriology
- Acupuncture

Sports & Leisure

FITNESS CENTRE

- ground pilates equipment
- 1 cardio room
- 1 fitness room
- 1 room dedicated to Kinesis and Power Plate

LAND SPORTS

- 3 tennis courts
- 1 squash court
- Table tennis
- Bocciball
- Dart Board
- Personal/group coaching*

WATER SPORTS

- Water Skiing
- Windsurfing
- Kayaking
- Sailing
- Glass bottom boat
- Snorkelling
- Stand-Up Paddle
- Wakeboarding
- Scuba Diving*
- Private boats excursions*

*Activities involving cost



Ti Royal

- Housed in a spacious facility dedicated to children aged 3 to 11.
- Opening hours from 9 a.m. to 11 p.m.
- A Babysitting service available on request with supplement (24-hour notice required).

BABY CARE AMENITIES

Upon request.

Practical Information

Concierge - Boutique - WI-FI/ADSL access - Limousine & helicopter transfers - Doctor on call - Press-Reader - Cigar Lounge - House florist - Practical information - Courtesy rooms (according to availability)

CREDIT CARDS

American Express, Visa, Mastercard, Diners. Personal and travellers cheques are not accepted.

NON-SMOKING POLICY

All our rooms and covered public areas within the hotel premises are non-smoking as per local regulations.

