

DREAM IS A SERIOUS THING



Sainte Anne
RESORT & SPA • SEYCHELLES



Located on a 220-hectare private island in the Indian Ocean, at the heart of a unique marine park and just 10 minutes by boat from Mahé, lies the spectacular natural haven of Sainte Anne Resort & Spa. Accommodation is housed in private villas set in a tropical forest. Renowned for its excellent service and gastronomy, the hotel also has a Spa by Clarins designed with a tropical slant.

Seychelles



Distances

The airport is close to Sainte Anne Resort & Spa's private wharf on Mahé. A 10-minute free boat transfer to Mahé is provided at scheduled times during the day.

Unique Selling Points |

- An all-villa resort
- Set on a private island at the heart of a marine park
- Located 10 minutes by boat shuttle from Mahé
- Dedicated and personalised service
- Spacious villas, including 29 with private pools, surrounded by tropical gardens
- One of the finest cuisines in the Seychelles
- A choice of five restaurants
- A tropical Spa by Clarins
- A sports and leisure centre
- An optional all-inclusive package, the "Island Inclusive Package"
- Complimentary WIFI access

Sainte Anne Resort & Spa

P.O. Box 388 • Victoria • Mahé
Seychelles • Indian Ocean

Tel: +248 429 20 00 • Fax: +248 429 20 02

E-mail: sainteanne@bchot.com

www.sainteanne-resort.com

DREAM IS A SERIOUS THING



"Island Inclusive Package" Unique Selling Points |

- Access to all bars and to the five restaurants of the hotel
- A wide-ranging choice of menus including buffets, menus, table d'hôte and "à la carte" menus
- Premium wines and famous brands of spirits
- Champagne by the glass as from 6 p.m.
- The mini-bar is included
- The package is combinable with Beachcomber special offers

N.B. See "Island Inclusive" fact sheet.



ACCOMMODATION |

87 VILLAS

- **26 Garden Villas** (150 m²)
 - Suite, terrace, gazebo, outdoor shower: 95 m²
 - Semi-private garden: 55 m² - 4 inter-leading pairs.
- **32 Tropical Villas** (150 m²)
 - Suite, terrace, gazebo, outdoor shower: 95 m² - Semi-private garden: 55 m²
 - 5 inter-leading pairs.
- **21 Pool Villas** (220 m²)
 - Suite, terrace, gazebo, outdoor shower: 95 m² - Garden and private pool: 125 m²
 - 1 villa inter-leading with 1 Tropical Villa.
- **3 Beach Villas with pool**
 - Suite, lounge, terrace, gazebo, outdoor showers: 161 m²
 - Garden and private pool: 319 m².
- **4 Senior Beach Villas with pool**
 - 2 suites, lounge, terrace, gazebo, outdoor showers: 234 m²
 - Garden and private pool: 363 m².
- **1 Royal Villa**
 - 3 suites, lounge, outdoor showers: 319 m²,
 - Terrace and sun deck: 91 m²,
 - Private pool: 16 m².

FEATURES OF THE VILLAS

All villas are single-storey and have the following facilities:

- Terrace
- Private garden and/or gazebo
- Individually controlled air-conditioning
- Private bathroom with bathtub, shower and separate toilets
- Hair-dryer
- Individual safe
- King-size bed
- Telephone with international direct dialing
- Television (satellite channels)
- DVD player
- Mini-bar with complimentary tea and coffee facilities
- WIFI access
- Electricity: 220 Volts

Additional services: Each villa provides complimentary bicycles and helmets. Free electric cart provided for the exclusive use of residents of the Beach Villas with pool, Senior Beach Villas with pool and the Royal Villa.

- Room service: 6 a.m. to 11 p.m. (tray charge)
- Smoking is permitted in selected open-air sections of some restaurants and bars. Smoking is not allowed outside those areas.

N.B. On arrival, check-in is at 2 p.m.
On departure, check-out is at noon.

VILLA CAPACITY

- **Garden Villa:** 2 adults + 2 children
- **Tropical Villa:** 2 adults + 2 children
- **Pool Villa:** 2 adults + 2 children
- **Beach Villa with pool:** 2 adults + 2 children + 1 infant (under 5 years)
- **Senior Beach Villa with pool:** 4 guests
- **Royal Villa:** 6 guests



OTHER SERVICES

- Kids club (for children aged 3 to 12)
- Library
- DVD player
- Complimentary access to WIFI
- Baby-sitter (24-hour notice)
- Infirmary (doctor on request)
- Boutique
- Excursions
- Car rental
- Helicopter transfers and excursions



Garden Villa



Tropical Villa

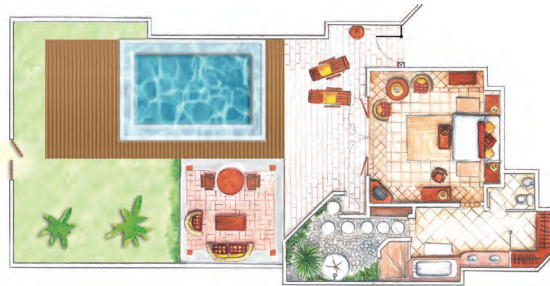

Pool Villa



Beach Villa with pool



Senior Beach Villa with pool



Royal Villa



ENTERTAINMENT

- Band or musicians 6 evenings a week

SPA BY CLARINS

- 5 single massage cabins • 2 double massage cabins • 1 Ayurvedic cabin
- 1 yoga room • 1 balneotherapy room
- Changing rooms • 2 hammams and 2 saunas reserved to the clients of the spa
- 1 beauty and hair salon

CONFERENCE ROOM

Capacity:

Classroom style: 30 pax.

Theatre style: 50 pax.

Equipment:

- Lectern • Flip chart • Pencil and paper
- Screen (2 m x 2 m) • Retroprojector
- Sound system • DVD player
- Additional equipment on request

N.B. Lunches and cocktails on request.

RESTAURANTS & BARS |

Dress code

- Daytime: casual
- Night-time:
 - smart casual (shirt and trousers)
 - Le Robinson & L'Océane: bermudas accepted

L'ABONDANCE - seats 110

Main restaurant overlooking the pool.

International cuisine.

- **Breakfast:** American buffet from 7.30 a.m. to 10.30 a.m.
- **Lunch:** buffet from 1 p.m. to 3 p.m.
- **Dinner:** themed buffets or "table d'hôte" from 6.30 p.m. to 9.30 p.m.

L'OCEANE - seats 24

Beach restaurant consisting of a string of thatched pavilions.

- **Lunch:** noon to 3.30 p.m.
Open from June to October.
Selection of salads and sandwiches
- **Dinner:** (on reservation)
Open 6 evenings a week
from 7 p.m. to 9.30 p.m.
"à la carte"*

LE MONT FLEURI - seats 60

Restaurant set on stilts high above the beach.

- Open 6 evenings a week.
- **Dinner:** (on reservation)
from 7.30 p.m. to 9.30 p.m.
Menus*

LE ROBINSON - seats 20

Beach restaurant lined with granite rocks and trees and located at the water's edge.

Open 6 evenings a week.

- **Dinner:** (on reservation) from 7 p.m. to 9.30 p.m.
Stone grill menu*
Lobster menu with supplement.

LE TAKAMAKA - seats 25

Beach restaurant and bar.

Open from November to end of April.

Open from 10 a.m. to 6 p.m.

Selection of drinks (fruit juices, iced tea).

- **Lunch:** from noon to 3.30 p.m.
Selection of salads and sandwiches

LE SANS-SOUCI Bar

Main bar overlooking the pool and sea.

Open from 10 a.m. to midnight.

Tropical cocktails and flavoured rum.

HEALTH Bar

Located at the sports and leisure centre.

*included in half-board package with supplement on certain items

LAND SPORTS

- Tennis (2 floodlit courts)
- Nature walk in the forest
- Stretching • Table tennis • Beach volley • Mini football • Tennis volley
- Jogging • Yoga • Bike excursions
- Boccia • Turtle watching

WATER SPORTS

- Kayak • Pedal boat • Laser
- Glass-bottom boat • Snorkelling

N.B. All sports and activities are free of charge except: scuba diving, tennis balls, personal training and entrance fee to Moyenne Island.

SPORTS & LEISURE CENTRE

- Cardio • Body-building
- Power plate • Hammam • Sauna
- Health bar • Billiard • Board games
- Changing rooms

NON-SMOKING POLICY

Smoking is permitted in selected open-air sections of some restaurants and bars. Smoking is not allowed outside those areas.

CREDIT CARDS

- American Express
- Visa
- Mastercard
- Diners

N.B. Personal cheques are not accepted.

USEFUL INFORMATION

Local currency: Seychelles rupee.

Sainte Anne
RESORT & SPA • SEYCHELLES

2013/2014



SCAN & REVEAL

beachcomber
HOTELS

WWW.BEACHCOMBER-HOTELS.COM

- 1 Quay & helipad
- 2 Reception
- 3 Conference room
- 4 Sports lounge & leisure centre
- 5 Tennis
- 6 Spa by Clarins
- 7 Kids club
- 8 Le Sans-Souci Bar
- 9 L'Abondance restaurant
- 10 L'Océane restaurant
- 11 Boat house
- 12 Diving centre
- 13 Le Robinson restaurant
- 14 Le Mont Fleuri restaurant
- 15 Le Takamaka restaurant
- 16 Beach Bar
- 17 Fire meeting point

"Garden Villas"

N° 100 - 104 / 505 - 524 / 538 - 539

"Tropical Villas"

N° 105 - 120 / 125 / 504

N° 525 - 529 / 540 - 549

"Pool Villas"

N° 121 - 124 / 500 - 503

N° 530 - 537 / 550 - 554

"Beach Villas with pool"

N° 300 / 600 - 601

"Senior Beach Villas with pool"

N° 200 - 202 / 700

"Royal Villa"

N° 400

Anse Royale

Villa 300

Villa 202

Villa 201

Villa 200

Villa 700

Villa 601

Villa 600

Grande Anse

Villas 534 - 554

Villas 500 - 533

Villa 400

Villas 105 - 125

Villas 100 - 104

Botanical Walk/Sentier botanique

Cocos de Mer

Giant tortoise park/
Enclos de tortues géantes

Kitchen Garden/
Potager

Anse Tortues

