

DREAM IS A SERIOUS THING

Valid as from 01.11.2014



Sainte Anne
ISLAND • SEYCHELLES



Located on a 220-hectare private island in the Indian Ocean, at the heart of a unique marine park and just 10 minutes by boat from Mahé, lies the spectacular natural haven of Sainte Anne Island. Accommodation is housed in private villas set in a tropical forest. Renowned for its excellent service and fine cuisine, the hotel also has a Spa by Clarins designed with a tropical slant.

Seychelles



Distances

The airport is close to Sainte Anne Island's private wharf on Mahé.
A 10-minute boat transfer to Mahé is provided at scheduled times during the day.

Unique Selling Points |

- The warm and personalised Beachcomber welcome for a memorable and pampering stay
- Private island located in idyllic surroundings, in the middle of a unique marine park
 - Close to Mahé, the main island, within a 10-minute boat ride
 - 3 beautiful beaches with at least 2 of them protected from prevailing winds all year round
 - Over 1.5 km of sandy beach
- A sanctuary of natural flora and fauna
 - A stunning underwater world ideal for snorkelling
 - Traditional nestling ground for sea turtles
 - Trekking paths to explore and discover the various facets of the island which include historical relics and botanical endemic species like the sea coconut
- A perfect resort for families
 - Accommodation adapted to families, with a majority of the villas providing two beds
 - A dedicated Kids Club with exciting activities oriented towards the discovery of nature
 - A variety of sports and leisure facilities that can be experienced by the whole family
- A choice of 4 restaurants
 - Each restaurant offers a different setting and atmosphere
 - Local cuisine made from a variety of home-grown products and fresh seafood

Sainte Anne Island

P.O. Box 388 • Victoria • Mahé
Seychelles • Indian Ocean

Tel: +248 429 20 00 • Fax: +248 429 20 02

E-mail: sainteanne@bchot.com

www.sainteanne-island.com



"Island Inclusive Package" Unique Selling Points |

- Is available from the time clients arrive at the hotel until 6 p.m. on departure day
- A choice of restaurants available
- A wide-ranging choice of menus including buffets, menus, table d'hôte and "à la carte" menus
- A large selection of drinks offered
- The package is combinable with Beachcomber special offers

N.B. See "Island Inclusive" fact sheet.



ACCOMMODATION |

87 VILLAS

- **26 Garden Villas** (150 m²)
 - Suite, terrace, gazebo, outdoor shower: 95 m²
 - Semi-private garden: 55 m² - 4 inter-leading pairs.
- **32 Tropical Villas** (150 m²)
 - Suite, terrace, gazebo, outdoor shower: 95 m² - Semi-private garden: 55 m²
 - 5 inter-leading pairs.
- **21 Pool Villas** (220 m²)
 - Suite, terrace, gazebo, outdoor shower: 95 m² - Garden and private pool: 125 m²
 - 1 villa inter-leading with 1 Tropical Villa.
- **3 Beach Villas with pool** (480 m²)
 - Suite, lounge, terrace, gazebo, outdoor showers: 161 m²
 - Garden and private pool: 319 m².
- **4 Senior Beach Villas with pool** (840 m²)
 - 2 suites, lounge, terrace, gazebo, outdoor showers: 234 m²
 - Garden and private pool: 606 m².
- **1 Royal Villa** (426 m²)
 - 3 suites, lounge, outdoor showers: 319 m²,
 - Terrace and sun deck: 91 m²,
 - Private pool: 16 m².

FEATURES OF THE VILLAS

All villas are single-storey and have the following facilities:

- Terrace
 - Private garden and/or gazebo
 - Individually controlled air-conditioning
 - Private bathroom with bathtub, shower and separate toilets
 - Hair-dryer
 - Individual safe
 - King-size bed
 - Telephone with international direct dialing
 - Television (satellite channels)
 - DVD player
 - WIFI access
 - Electricity: 220 Volts
- Additional services with supplement:**
- Minibar
 - Bicycles
 - Electric carts

- Room service: 7.30 a.m. to 9.30 p.m. (tray charge)
- Smoking is permitted in selected open-air sections of some restaurants and bars. Smoking is not allowed outside those areas.

N.B. On arrival, check-in is at 2 p.m.
On departure, check-out is at noon.

VILLA CAPACITY

- **Garden Villa:** 2 adults + 2 children
- **Tropical Villa:** 2 adults + 2 children
- **Pool Villa:** 2 adults + 2 children
- **Beach Villa with pool:** 2 adults + 2 children + 1 infant (under 5 years)
- **Senior Beach Villa with pool:** 4 guests
- **Royal Villa:** 6 guests



OTHER SERVICES

- Kids club (for children aged 3 to 12)
- Library
- DVD player
- Complimentary access to WIFI
- Baby-sitter (24-hour notice)
- Infirmary (doctor on request)
- Boutique
- Excursions
- Car rental
- Helicopter transfers and excursions



Garden Villa



Tropical Villa

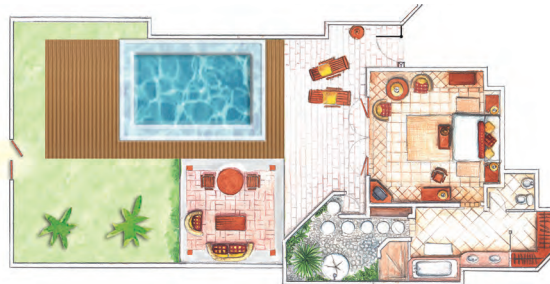

Pool Villa



Beach Villa with pool



Senior Beach Villa with pool



Royal Villa



ENTERTAINMENT

- Band or musicians 6 evenings a week

SPA BY CLARINS

- 5 single massage cabins • 2 double massage cabins • 1 Ayurvedic cabin
- 1 yoga room • 1 balneotherapy room
- Changing rooms • 2 hammams and 2 saunas reserved to the clients of the spa
- 1 beauty and hair salon

CONFERENCE ROOM

Capacity:

Classroom style: 30 pax.

Theatre style: 50 pax.

Equipment:

- Lectern • Flip chart • Pencil and paper
 - Screen (2 m x 2 m) • Retroprojector
 - Sound system • DVD player
 - Additional equipment on request
- N.B. Lunches and cocktails on request.

RESTAURANTS & BARS |

Dress code

- Daytime: casual
 - Night-time:
- smart casual (shirt and trousers)

L'ABONDANCE - seats 110

Main restaurant overlooking the pool.

International cuisine.

- **Breakfast:** American buffet from 7.30 a.m. to 10.30 a.m.
- **Lunch:** buffet from 1 p.m. to 3 p.m.
- **Dinner:** buffet from 6.30 p.m. to 9.30 p.m.

LE MONT FLEURI - seats 60

Restaurant set on stilts high above the beach.

Open 6 evenings a week.

- **Dinner:** (on reservation) from 7 p.m. to 9.30 p.m.
- "à la carte" with supplement

LE ROBINSON - seats 25

Beach restaurant lined with granite rocks and trees and located at the water's edge.

Open 3 evenings a week. The resort reserves the right to close the restaurant during very low season.

Open from May to October.

- **Lunch:** from noon to 3.30 p.m. Selection of salads and sandwiches
- **Dinner:** (on reservation) from 7 p.m. to 9.30 p.m. Hotstone/lobster menu with supplement

LE TAKAMAKA - seats 25

Beach restaurant.

Open from November to end of April.

- **Lunch:** from noon to 3.30 p.m. Selection of salads and sandwiches

LE SANS-SOUICI Bar

Main bar overlooking the pool and sea.

Open from 10 a.m. to 11.30 p.m.

Tropical cocktails and flavoured rum.

BEACH BAR

Open from 10 a.m. to 5 p.m.

Selection of drinks (fruit juices, iced tea).

SPORTS Bar

Located at the sports and leisure centre.

LAND SPORTS

- Tennis (2 floodlit courts)
- Nature walk in the forest
- Stretching • Table tennis • Beach volley • Mini football • Tennis volley
- Jogging • Yoga • Bike excursions
- Boccia • Turtle watching

WATER SPORTS

- Kayak • Pedal boat
- Laser • Stand-up paddle
- Glass-bottom boat • Snorkelling

N.B. All sports and activities are free of charge except: scuba diving, tennis balls, personal training and entrance fee to Moyenne Island and fishing trips.

SPORTS & LEISURE CENTRE

(as from 14 years old)

- Cardio • Body-building
- Hammam • Sauna
- Billiard • Board games
- Changing rooms

NON-SMOKING POLICY

Smoking is permitted in selected open-air sections of some restaurants and bars. Smoking is not allowed outside those areas.

CREDIT CARDS

- American Express
- Visa
- Mastercard
- Diners

N.B. Personal cheques are not accepted.

USEFUL INFORMATION

Local currency: Seychelles rupee.

Sainte Anne
ISLAND • SEYCHELLES

2014/2015



SCAN & REVEAL

beachcomber
HOTELS

WWW.BEACHCOMBER-HOTELS.COM

- 1 Quay & helipad
- 2 Reception
- 3 Conference room
- 4 Sports lounge & leisure centre
- 5 Tennis
- 6 Spa by Clarins
- 7 Kids club
- 8 Le Sans-Souci Bar
- 9 L'Abondance restaurant
- 10 Boat house
- 11 Diving centre
- 12 Le Robinson restaurant
- 13 Le Mont Fleuri restaurant
- 14 Le Takamaka restaurant
- 15 Beach Bar
- 16 Fire meeting point

"Garden Villas"

N° 100 - 104 / 505 - 524 / 538 - 539

"Tropical Villas"

N° 105 - 120 / 125 / 504

N° 525 - 529 / 540 - 549

"Pool Villas"

N° 121 - 124 / 500 - 503

N° 530 - 537 / 550 - 554

"Beach Villas with pool"

N° 300 / 600 - 601

"Senior Beach Villas with pool"

N° 200 - 202 / 700

"Royal Villa"

N° 400

Anse Royale

Villa 300

Villa 202

Villa 201

Villa 200

Villas 105 - 125

Villas 100 - 104

Villa 700

Villa 601

Villa 600

Grande Anse

Villas 534 - 554

Villas 500 - 533

Villa 400

Botanical Walk/Sentier botanique

Cocos de Mer

Giant tortoise park/
Enclos de tortues géantes

Kitchen Garden/
Potager

Anse Tortues

